

Riggs Intersection Water Line Installation [Part 2/2]

Logistics Plan

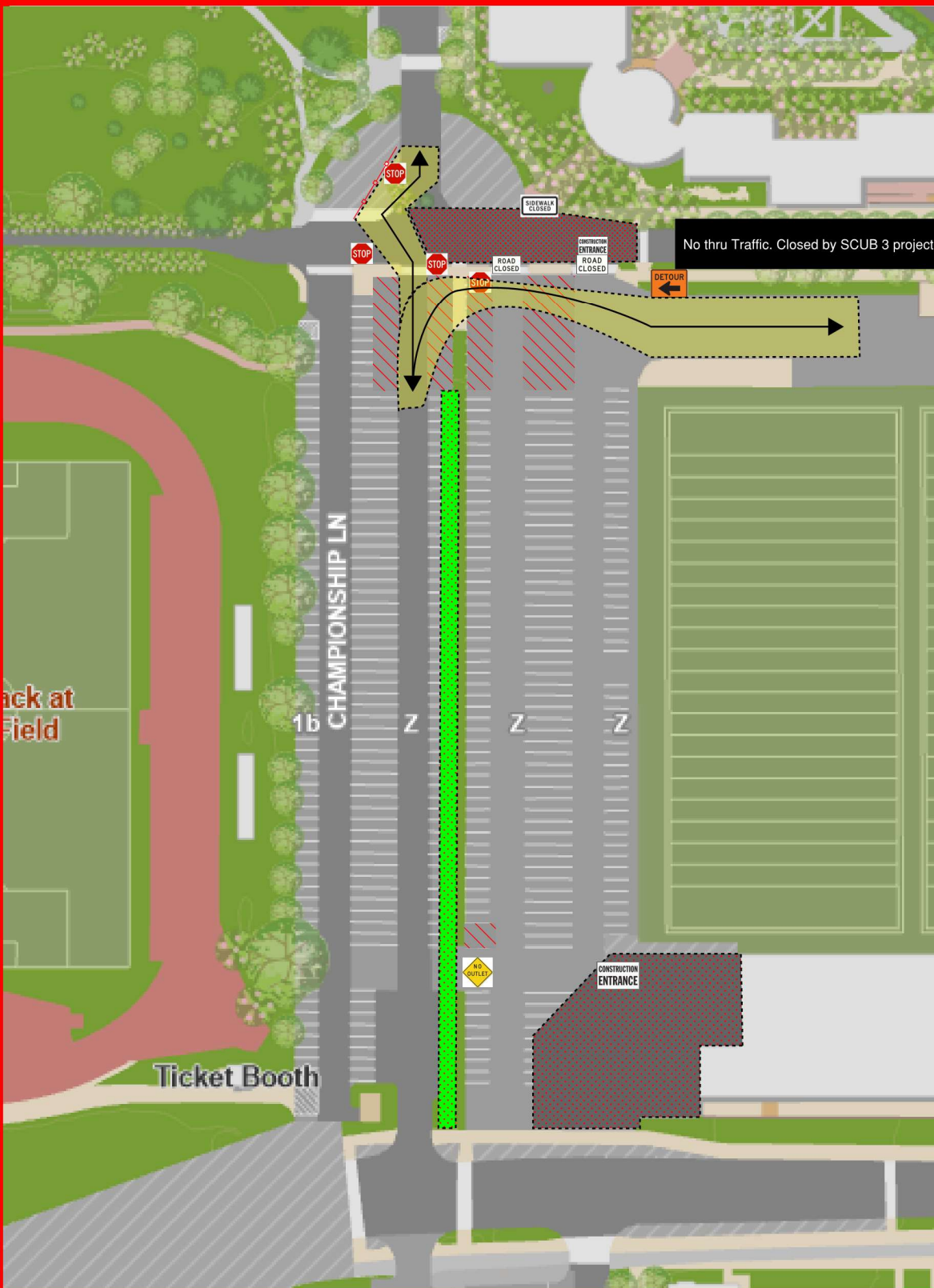
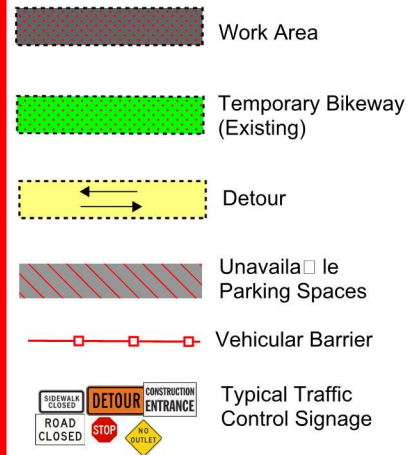

Notification Narrative:

Construction Activities: 6/16/2025 thru 6/30/2025

Lot Z Drive Lane: Two way traffic to remain open

Bikeway Segment 1-B: To be re-routed with vehicular traffic

Jones-Hill House Loading Dock: No egress from Field House Drive. Access must come from Lot Z.

**Health and Human Sciences
Complex**