

Lot Z
Water & Storm Line Installation
[Part 1/2]

Logistics Plan

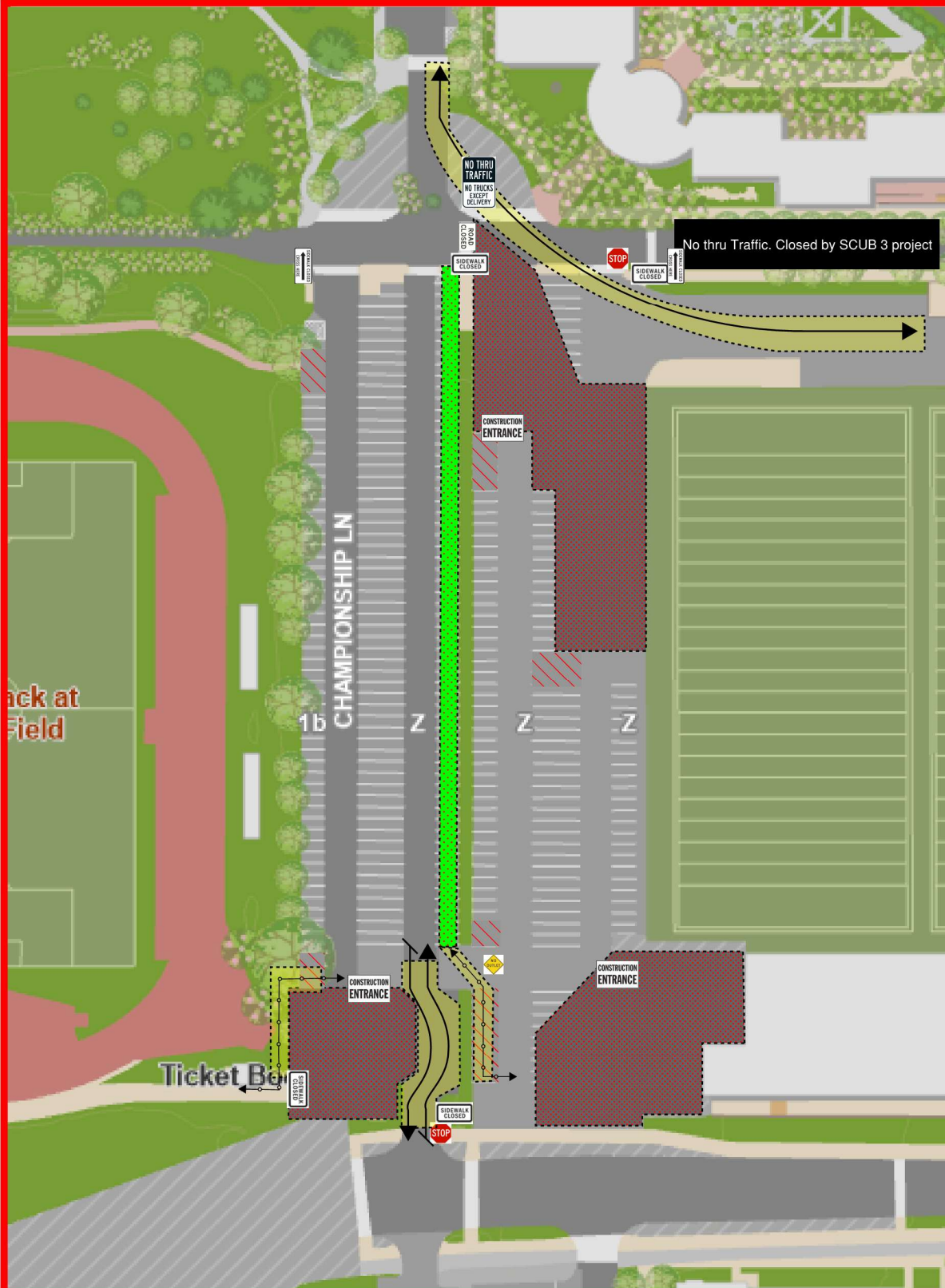
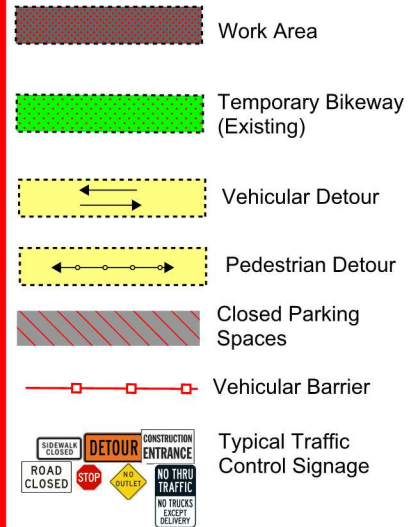

Construction Activities: 6/30/2025 thru 7/15/2025

Lot Z Drive Lane: Two way traffic to remain open

Jones-Hill House Loading Dock: No egress from Lot Z. Access must come from Alumni Drive.

Temporary Bikeway: To be re-routed with traffic at Lot Z entrance from Union Drive

Ludwig Field: Existing Media gate entrance to be re-purposed as ADA entrance. Media entrance relocated to the north gate

**Health and Human Sciences
Complex**