

**Lot Z**  
**Water & Storm Line Installation**  
**[Part 2/2]**

**Logistics Plan**

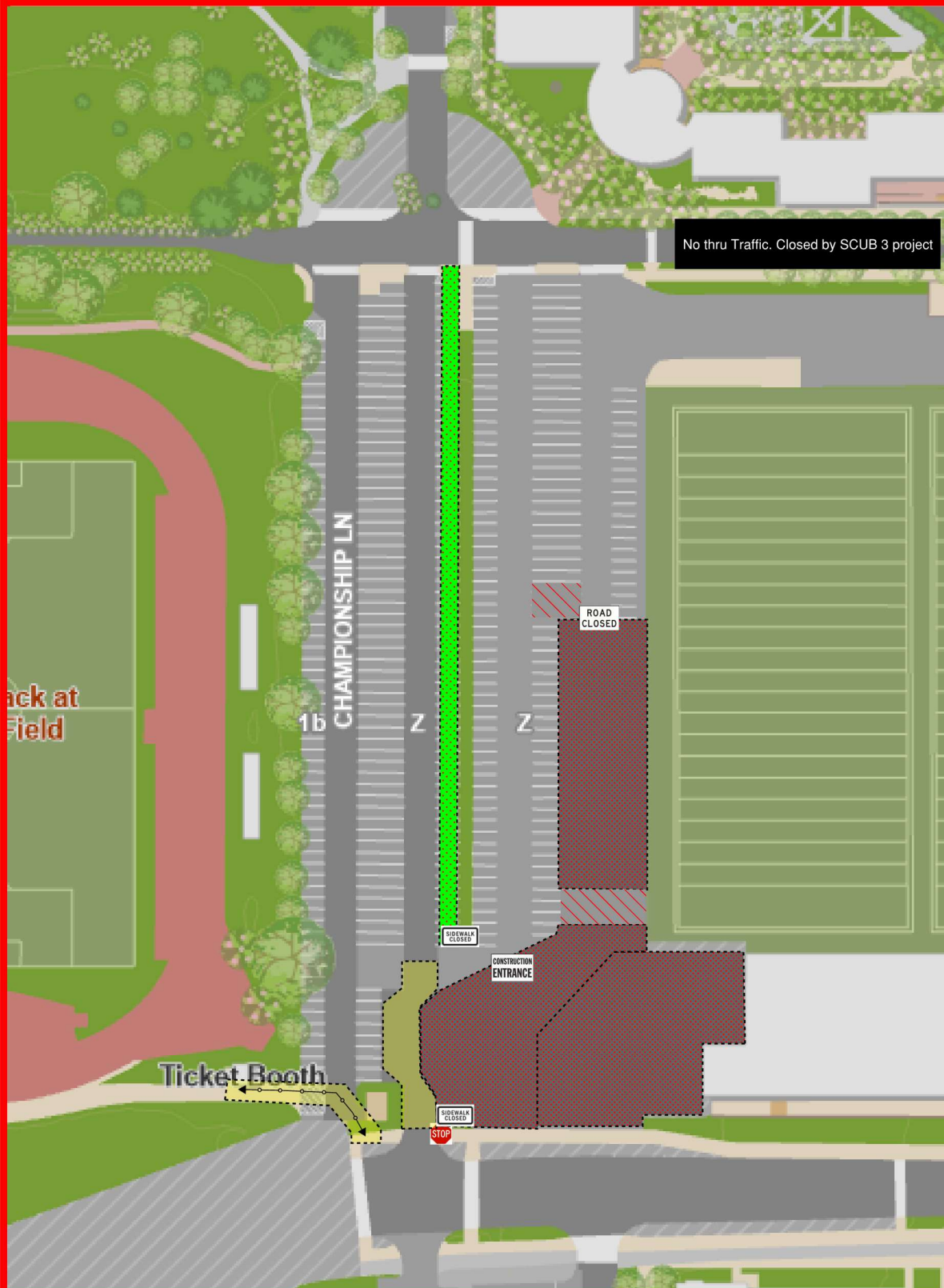
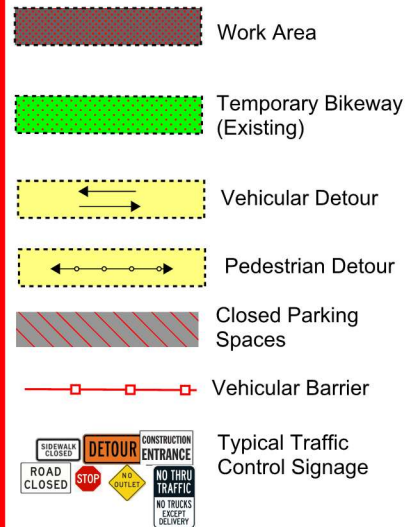

**Construction Activities:** 7/14/2025 thru 8/01/2025

**Lot Z Drive Lane:** Two way traffic to remain open

**Temporary Bikeway:** To be re-routed with traffic at Lot Z entrance from Union Drive

**Ludwig Field:** Pedestrian Access to detour onto Union Drive Sidewalk

**Jones-Hill House Field:** Emergency Access to remain from Lot Z.

**Health and Human Sciences Complex**